

FOUR PICKLEBALL COURTS ORIENTED EAST - WEST
OPTION A

NOTES:
 2" LINE WIDTHS
 NET POST EXTEND 12" BEYOND SIDE LINES

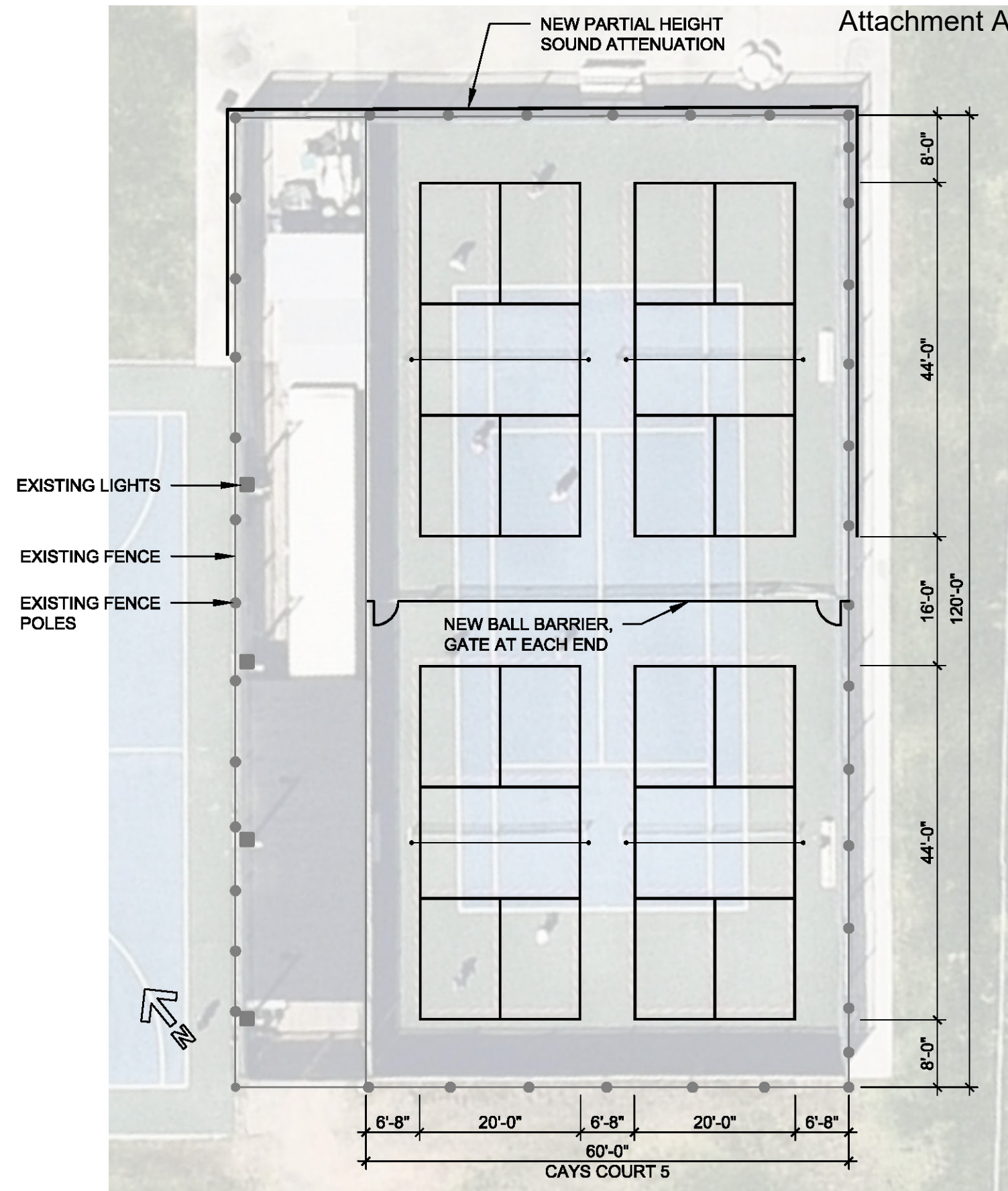

FOUR PICKLEBALL COURTS ORIENTED NORTH - SOUTH
OPTION B

CAYS PARK PICKLEBALL COURTS AT CAYS COURT 5

SCALE: 1/16" = 1'-0"

NOTES:
2" LINE WIDTHS
NET POST EXTEND 12" BEYOND SIDE LINES

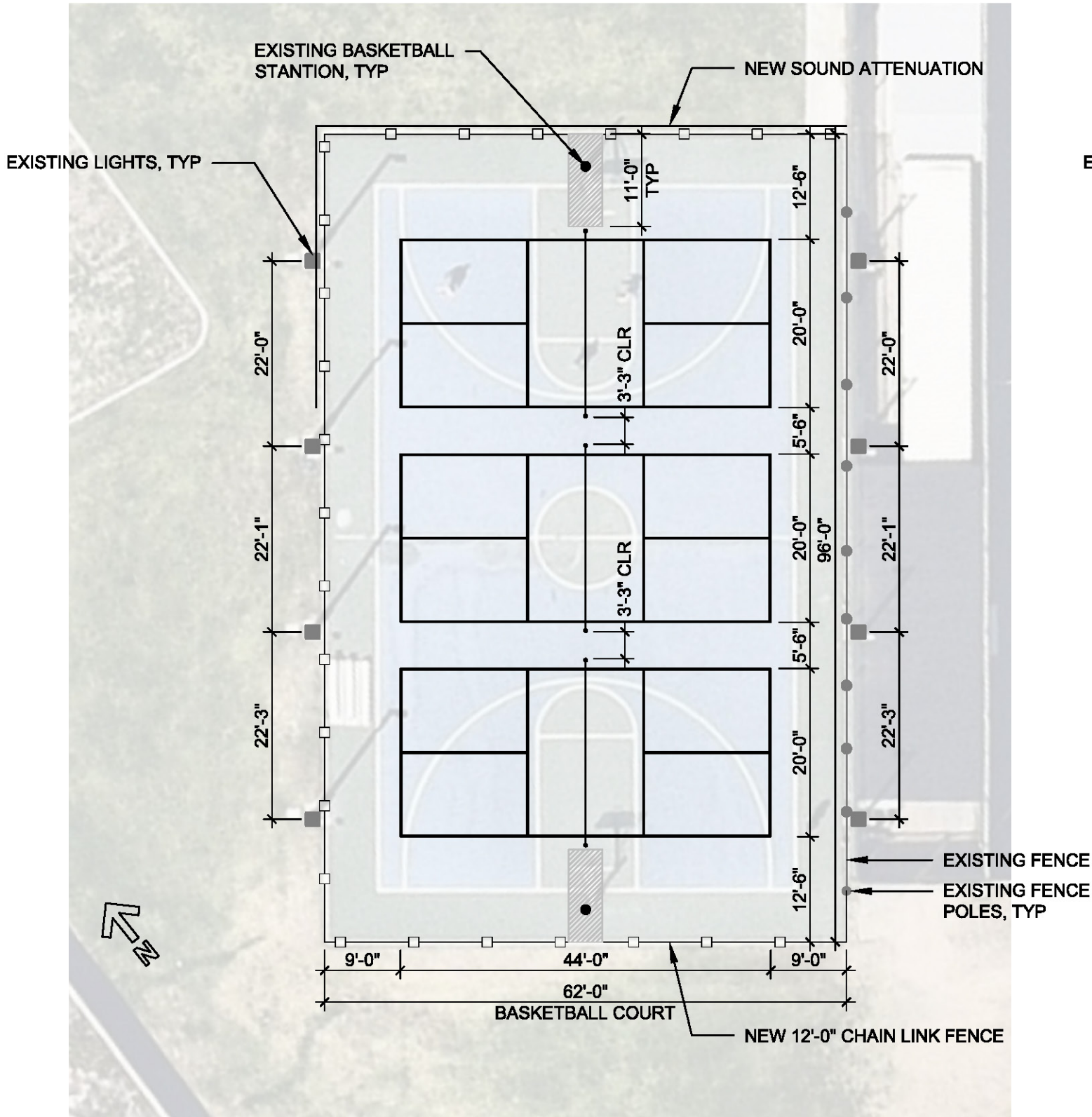

SHARED COURT - THREE PICKLE BALL COURTS ORIENTED EAST - WEST
OPTION A

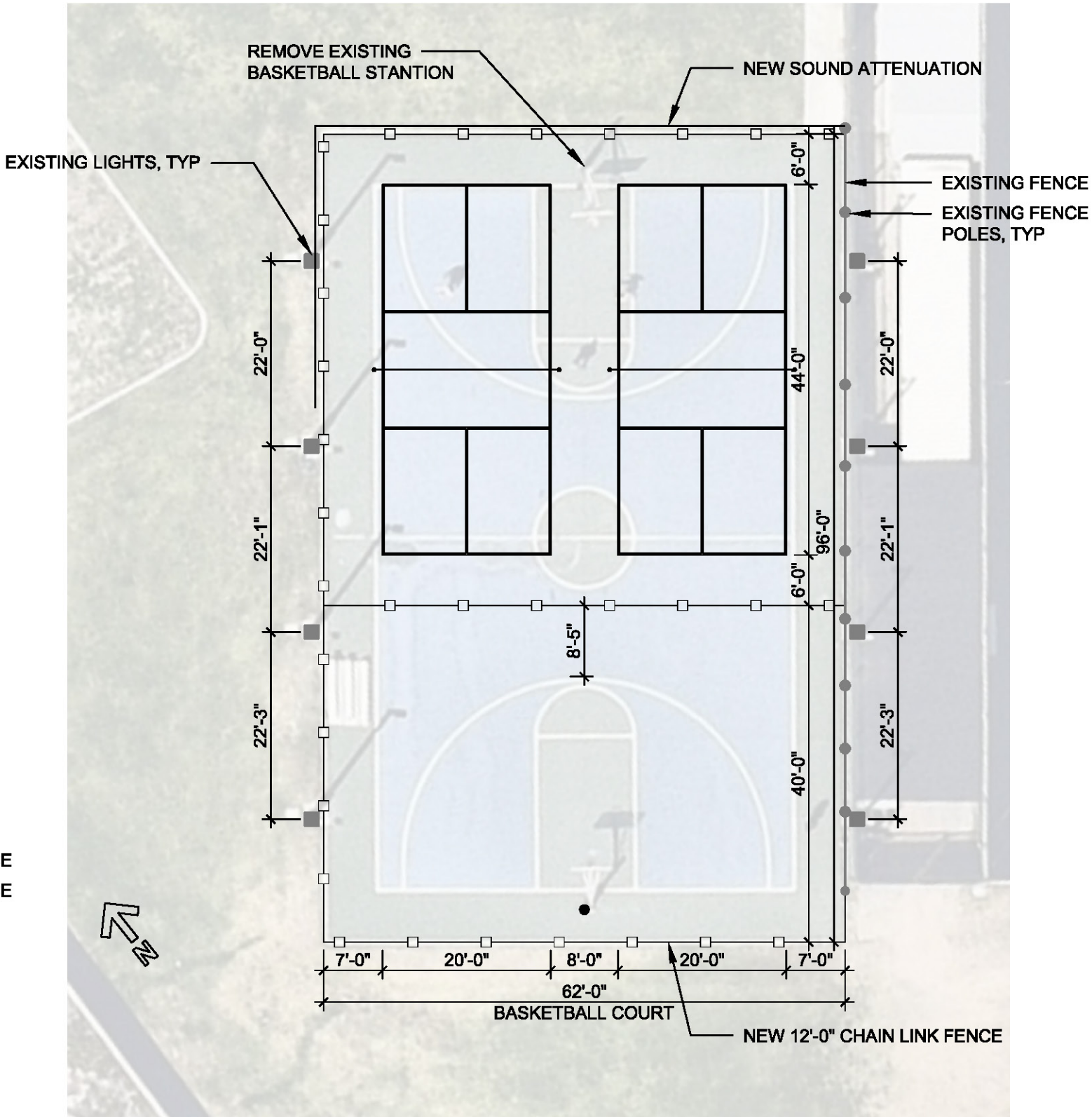

DIVIDED COURT - TWO PICKLE BALL COURTS ORIENTED NORTH - SOUTH
OPTION B

CAYS PARK PICKLEBALL COURTS
AT EXISTING BASKETBALL COURT